



**REAR STORAGE  
COMPARTMENT  
PRODUCTS**

**FOR**

**1968-82 CORVETTES**

# INTRODUCTION

This catalog is dedicated to the Corvette rear storage compartment. I originally started out reproducing a few select parts for the rear storage compartment (RSC) and then recognized the demand for an easier way to restore an interior. I remember spending hours of valuable time trying to make an old RSC look new again.

If your Corvette is like most, the doors do not open easily. The plastic frames are usually cracked or missing. Pull handles are broken, hinges are rusted and binding. In other words, it requires a complete restoration, or better yet, a pre-assembled unit. DeWitts offers assembled RSC units in more than sixty different color configurations, a route most interior restoration shops take because of the time and money it saves.

I recommend the assembled RSC units over buying individual components, but I'm not going to limit your options. Therefore, we have broken down each design into individual parts to allow the do-it-yourselfer the ability to purchase parts separately. DeWitts specialty is the RSC area. We do not offer a full line of Corvette parts and accessories. I highly recommend that retail customers purchase our products from a Corvette shop that can provide all your interior needs. This method will help insure that all your interior components will match. We have an established dealer network and we can refer you to one in your area.

If you elect to make your purchase directly with us, we'll be happy to do business with any Corvette owner. Just make sure that you have previously determined all the parts you'll need and use our part numbers when ordering. Anyone with a fax machine can order anytime 24 hours a day. We also have our answering machine on during off hours or during shows so we don't miss your important call. You can also order online at

[www.dewitts.com](http://www.dewitts.com)

## QUALITY STATEMENT

The word gets around in the Corvette aftermarket. Ask Corvette owners and dealers about the quality of DeWitt's products and I'm sure you will find us second to none. I take great pride in what we sell and in American made products. That's why everything you find in this catalog is made in the U.S.A.

## OUR COLOR MATCH POLICY

There are many variables that come into play when trying to match an interior carpet color. The only way to guarantee a RSC will be a perfect color match is to supply the carpet pieces from a new carpet set. If you're trying to match an old or faded original interior, carefully remove the carpet from the doors and send these carpet pieces. This will involve removing the door trim frames in order to get the whole piece of carpet.

Orders placed for pre-assembled units without customers supplied carpet are made to order, using our carpet. Our standard carpet is manufactured by Auto Custom Carpet however, others are available upon request. Units made with new carpet will not be a perfect match to an old faded interior or another brand of carpet. Due to this fact, units are not returnable. The customer accepts the fact that the carpet dye lots will vary and that a perfect match is almost impossible.



# COMPLETE ASSEMBLED UNITS

The chart below lists our standard units and their respective color code. Throughout this catalog the “200” series numbers refer to parts for a (2) two door design and the “300” series numbers are for the (3) three door design. Units are categorized into three groups. Each group of units has a parent number and you add the color code to the end.

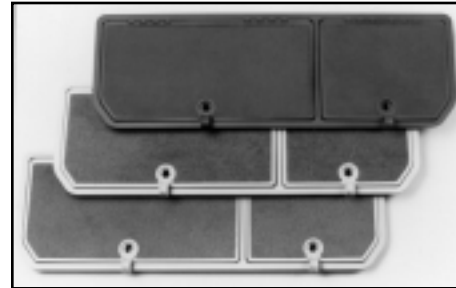

## 1968-76 3-DOOR RSC LOOP

YEAR	COLOR	CODE
68-76	BLACK	16
74-75	SILVER	24
68-72	RED	28
71-72	D. SADDLE	31
68	MED. BLUE	32
71-72	MED. BLUE	32
70	L. SADDLE	34
68-69	SADDLE	35
68-69	GUNMETAL	36
68-70	BRT. BLUE	37
69	GREEN	38
70	GREEN	40
71	BLUE/GREEN	41
73	D. SADDLE	42
73-74	OXBLOOD	43
73-74	MID. BLUE	44
73-75	MED. SADDLE	45
76	BLUE/GREEN	47
76	FIRETHORN	48
76	BUCKSKIN	50

**320\*\***

## 1970-79 3-DOOR RSC CUT PILE

YEAR	COLOR	CODE
70-79	BLACK	16
74-75	SILVER	24
70-72	RED	28
71-72	D. SADDLE	31
71-72	MED. BLUE	32
70	SADDLE	34
70-72	BRT. BLUE	37
70	GREEN	40
71	BLUE/GREEN	41
73	D. SADDLE	42
73-75	OXBLOOD	43
73-75	MID. BLUE	44
73-75	MED. SADDLE	45
76	BLUE/GREEN	47
76	FIRETHORN	48
76	BUCKSKIN	50
76	SMOKE/GREY	51
76-78	BROWN	52
77	INDIGO/BLUE	53
77	BUCKSKIN	54
77	SMOKE/GREY	55
77-79	BRT. RED	56
78	SILVER	57
78	SAFFRON	58
78	OYSTER	59
78	DOESKIN	60
78-79	MID. BLUE	61
79	DOESKIN	62
79	OYSTER	79

**321\*\***

## 1979-82 2-DOOR RSC CUT PILE

YEAR	COLOR	CODE
79-81	BLACK	16
79	D. GREEN	27
79-80	RED	56
79-80	OYSTER	59
79-80	DOESKIN	60
79-81	MID. BLUE	61
80	CLARET	63
81	SILVER	64
81	CINNABAR	65
81-82	D. DOESKIN	66
81-82	D. RED	67
81-82	CHARCOAL	68
82	SLATE/GREY	69
82	SILVER/GRN	70
82	MID. BLUE	71
82	COLLECTOR	73
81	RED	83

**220\*\***

\*\* Add color code to parent number



# COMPONENTS

## COMPARTMENT SURROUND FRAMES



**#308 • 68-79 MODELS**



**#208 • 79-82 MODELS**

These reproduction surround frames feature the same grained surface as the original part. Each part has all the mounting holes pre-drilled, ready to install. Molded in black ABS plastic. These parts can be painted to match your interior. Made in U.S.A.

## SURROUND SCREW KIT



**#330**  
68-79 MODELS

**#230**  
79-82 MODELS

These mounting screws are available as a separate item. Each kit includes the special chrome flange screws and black oxide screws required to mount the frame.

## HINGE SET

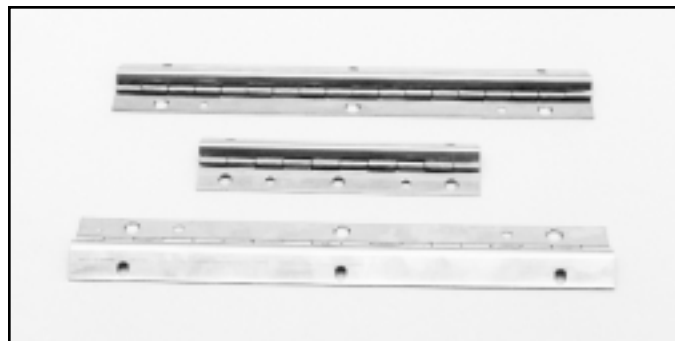

**#350 • 68-79 MODELS**

STAINLESS STEEL DOOR HINGE SET (3 pc)

- Better than original
- No rust!
- Prevents door binding
- No painting required

## BATTERY DOOR SEAL

**#316**



# REAR STORAGE COMPARTMENTS

## COMPARTMENT DOOR TRIM FRAMES

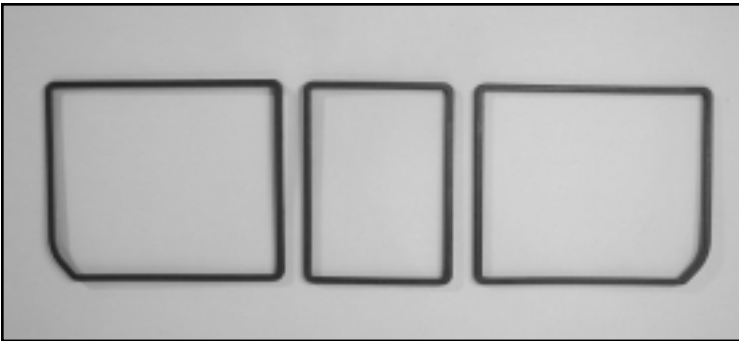

68-79 (1st DESIGN 79)

- Original grained surface
- Pre-drilled mounting holes
- Supplied in black ABS
- Made in U.S.A.

#305 • 68-79 MODELS

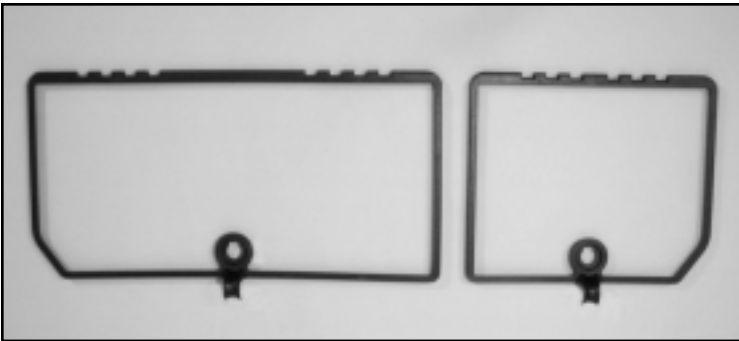

79-82 (2nd DESIGN)

- Original grained surface
- Handle molded in frame
- Supplied in black ABS
- Made in U.S.A.

#205 • 79-82 MODELS

## HANDLE SET



#302 • \*\*specify code

68-79 (3 DOOR-LOOPS)

- Heavy vinyl material
- Metal eyelet reinforced
- Available in all colors
- Screws and nuts included

## STRIKER KITS

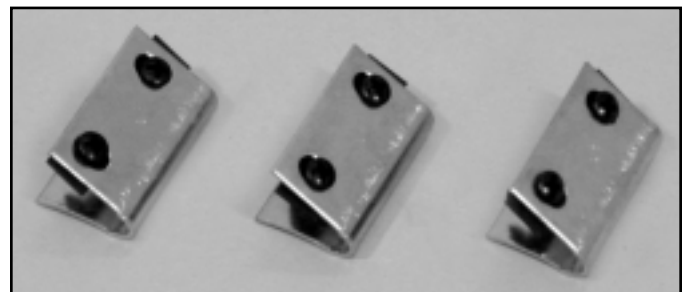

#307 • 68-79 (3)

#207 • 79-82 (2)

68-82 MODELS

Kit includes:

- Cadmium plated strikers
- Phosphate coated nut plates
- Black oxide screws



# REAR STORAGE COMPARTMENTS

## FIBERBOARD DOORS

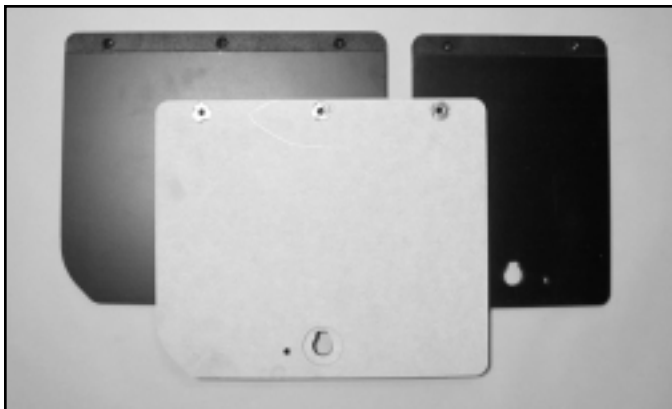

#314 • 68-79 MODELS

### REPLACEMENT BOARDS

- Identical to the original boards used on 68-73 models
- Black underside

## INSTRUCTION DECALS



#334 • 68-72 MODELS

Kit includes (1) one each of the following:

- Jacking instructions
- Tire pressure
- Maintenance schedule

## STRAP KIT



#202 • 79-82 MODELS

- Prevents door breakage
- Correct coated wire and ends
- Includes (2) two black hex screws and (2) two plastic retainers

## STAINLESS STEEL LIFT TABS



#304 • 68-79 MODELS

(3 PC SET)

- Factory equipment on 78-79
- Eliminates vinyl handle on 68-77
- Requires no modifications
- Installs in minutes

## BUMPER KIT

#100 • 68-82 MODELS

Kit includes (6) six rubber door bumpers

# COMPARTMENT TRAYS

## GM RESTORATION TRAYS



The two trays below are reproduced with original GM tooling and licensed by General Motors.



#315 • 68-79 MODELS

### WOODFIBER TRAY

- Correct woodfiber
- Beautifully flocked inside
- Shallow design for 72-79
- Made in U.S.A.



#206 • 79-82 MODELS

### PLASTIC TRAY

- Black ABS plastic
- Original GM molds
- Made in U.S.A.



#306 • 68-79 MODELS

### REPLACEMENT TRAY

- Functional replacement
- Stronger than original
- Black flocked inside
- Made in U.S.A.

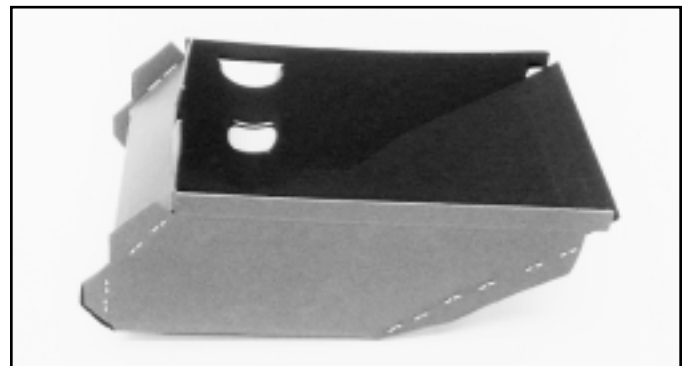

#309 • 68-76 MODELS

### CENTER COMPARTMENT

- Correct black board
- Black flocked as original
- Shield and lens installed
- Made in U.S.A.

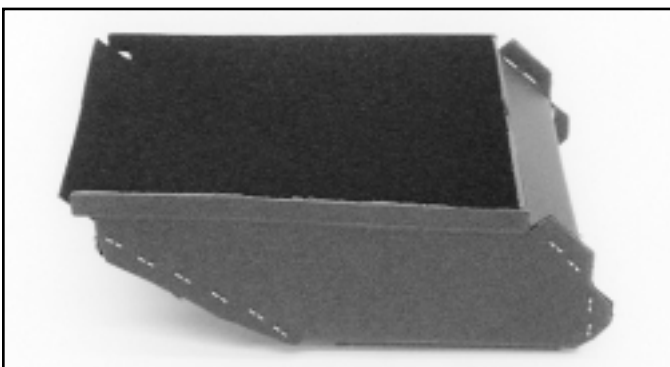

#310 • 77-82 MODELS

### CENTER COMPARTMENT

- Same as 309 without shield and lens
- Made in U.S.A.



# CUSTOM COMPARTMENT COOLERS

These aftermarket cooler trays can be used to keep a few cans of your favorite beverage cold when you are on that short trip. They are made of strong black ABS plastic. The factory side finger holes have been eliminated to allow for higher levels of water. Each tray is supplied with a hose and bushing for installing the automatic drain option.



#326 • 68-79 MODELS

**COOLER**

#226 • 79-82 MODELS

**COOLER**



# 68-79 REAR STORAGE COMPARTMENT

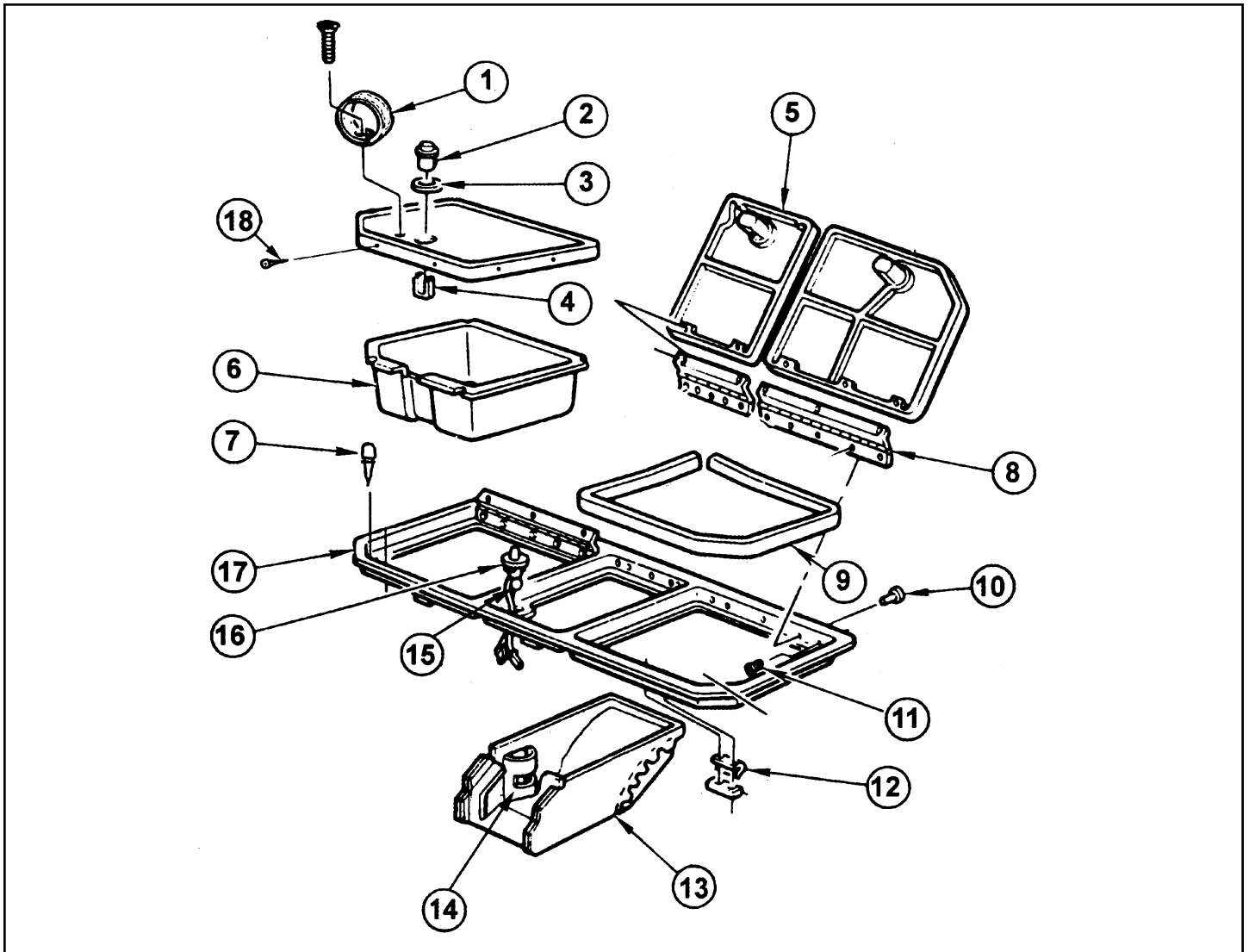

1	302	DOOR PULLS (3PC)
2A	101	PUSH BUTTON
2B	102	LOCK WITH KEY
3	304	S.S. LIFT TABS
4	303	LOCK RETAINER KIT (3PC)
5	305	DOOR TRIM FRAMES (3PC)
6A	306	PLASTIC REPLACEMENT TRAY
6B	315	WOOD-FIBER TRAY
6C	326	ICE TRAY
7	100	BUMPERS (6PC)
8	350	S.S. HINGE SET (3PC)

9	316	DOOR SEAL
10	319	CORRECT RIVETS (6PC)
11	330	MAIN FRAME SCREW KIT
12	307	STRIKER KIT
13A	309	CENTER TRAY W/ LIGHT
13B	310	CENTER TRAY W/O LIGHT
14	336	LENS
15	335	BULB
16	318	SWITCH
17	308	MAIN FRAME
18	317	TRIM FRAME SCREW KIT

# 79-82 REAR STORAGE COMPARTMENT

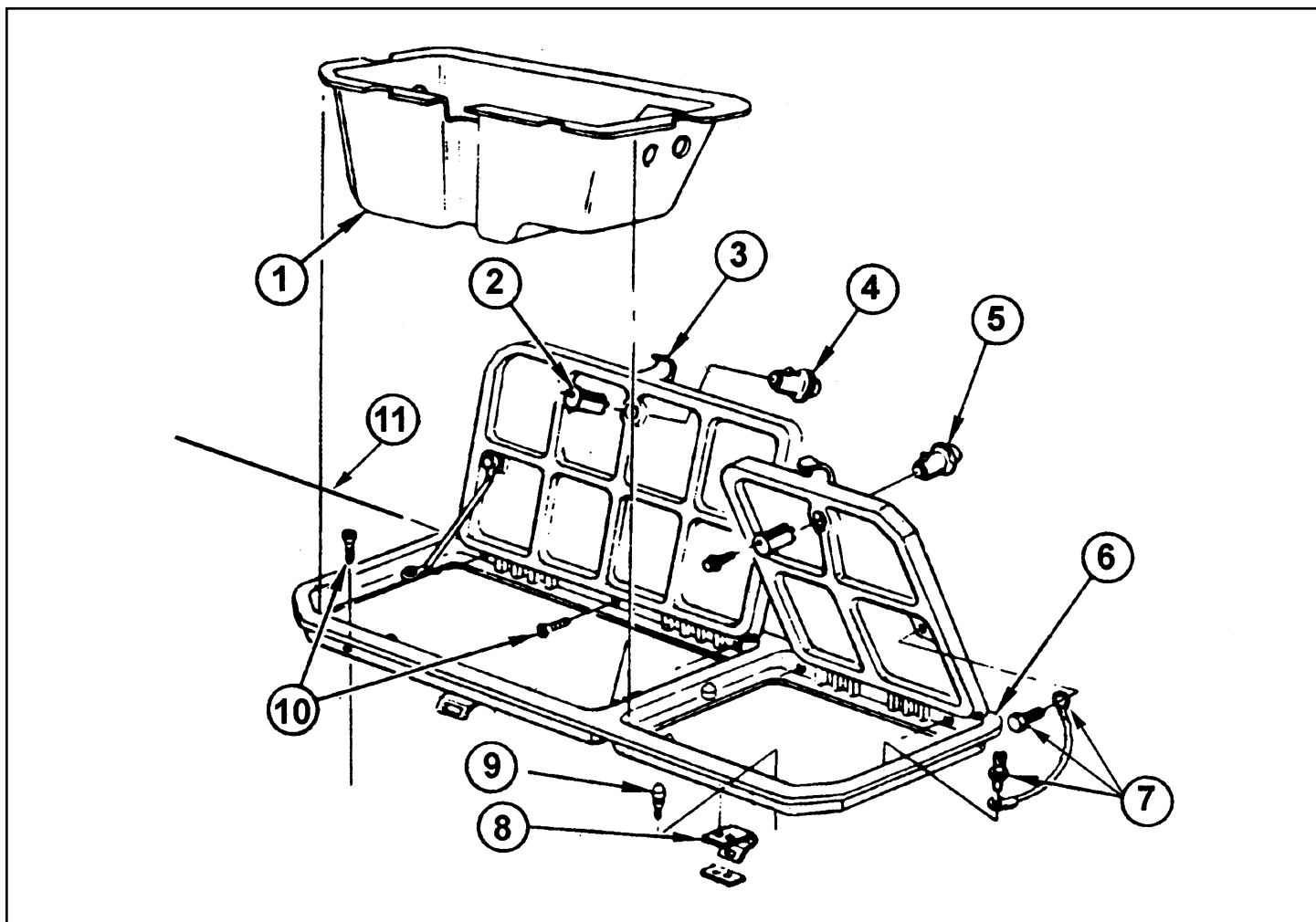

1A	206	CORRECT ABS PLASTIC TRAY (GM LICENSED)
1B	226	ICE TRAY-SIMILAR TO ABOVE WITHOUT HOLES
2	203	LOCK RETAINER KIT (2PC)
3	205	DOOR TRIM FRAMES (2PC SET)
4	102	LOCK WITH KEY
5	101	PUSH BUTTON
6	208	MAIN FRAME
7	202	STRAP KIT
8	207	STRIKER KIT
9	100	BUMPER KIT (6PC)
10	230	MAIN FRAME SCREW KIT
11	204	HINGE PINS

# Did you know...

The design of the rear compartment area includes many changes in its 15 year history. Beginning in 1968, the rear compartment doors were completely different from the one piece board used in previous mid-year corvettes. **Three separate compartments** were divided by a large plastic frame. Each compartment was covered with a door or lid that mounted to a hinge.

All the compartments had a unique purpose to utilize this space. The left compartment (driver side) provided a place to store the battery, the first time this was inside the vehicle. The right side, equal in size to the left, contained the vehicle jack. The jack was covered with a felt lined tray for storing loose items. The center (glove box) was the smaller of the three and was intended to hold the owners manual.

The early model 1968 compartment doors utilized a **spring loaded hinge** to “pop” the doors open when the lock cylinder was pressed. This concept did not prove successful and a small **vinyl loop** (handle) was added to assist in lifting the door.

The basic design remained the same for the 1968 thru 1972. The 1970 model introduced **cut-pile carpet** that was included with the **leather interior option**. In 1973, the first major change was made to the door base material. The solid fiberboard doors were replaced with a press molded plastic material. While the top appearance was unchanged, the bottom of the doors were no longer flat. The new plastic process provided a recessed and ribbed bottom. The **plastic door frames** were not mounted with screws, instead these were molded onto the doors with the carpet in one process.

The 1976 models were the last year to offer the 80/20 loop type carpet. In 1977, cut-pile was standard equipment and used on both vinyl and leather interiors.

The last major design change was in the middle of the 1979 production year. The three (3) compartment doors were reduced to a **two (2) door design**. This was originally scheduled to be a 1980 model change, however the parts for the three doors design were depleted early due to a record number of vehicles produced, thus creating the only model to have both designs.

The new 1979 (2nd design) two (2) door compartments utilized all new parts. The old center area was added to the right compartment to make a larger storage area. The large surround frame incorporates a reinforced ribbed area to serve as a hinge. The doors are attached to the surround frame using a wire type pin, eliminating the hinges. The door trim frames include the lock bezel and handle molded as one piece. This remained unchanged until the final year in 1982.

[www.dewitts.com](http://www.dewitts.com)



*Distributed by:*



**DeWitt's Reproductions**  
(810) 220-0181 • FAX (810) 220-0182  
[www.dewitts.com](http://www.dewitts.com)